



## Voltaire Road, Clapham, SW4

2 bedroom flat - conversion for sale

£500,000

Leasehold

### Property Details

A two bedroom apartment with a private terrace on Voltaire Road. The property has a lovely Victorian façade and is nestled in a highly sought after location, popular for its character, feel and proximity to Clapham High Street. The heart of the home is the spacious semi-open-plan reception, bathed in natural light through the square bay windows. Ideal for entertaining guests, hosting dinner parties or simply relaxing within the lounge, dimensions allow for comfortable living within a stylish, modern environment. The kitchen is equipped with modern, semi-integrated appliances and plenty of storage space. Neatly tucked to one side, the kitchen runs along one wall, maximising the space whilst not interrupting the flow of light. The private roof terrace is quietly tucked to the side of the property, allowing for a serene retreat from the hustle and bustle. Both bedrooms are well proportioned with plenty of space for traditional bedroom fittings. The family bathroom sits between the bedrooms, allowing for a level of privacy. Equipped with a bathtub and overhead shower, perfect for a soak in the tub after a stroll around Clapham Common. There is a parking restriction in place, mitigated by the excellent transport links on your doorstep.

Council tax band D

EPC rating C (72)

### Features

- Two double bedrooms
- Private roof terrace
- Victorian conversion
- Bright and airy atmosphere throughout
- Fantastic location, moments from Clapham High Street
- Excellent transport links with Northern Line and Overground both under five-minute's walk
- A short walk to Clapham Common and Larkhall Park
- Share of freehold will be granted
- Chain free





Voltaire Road, Clapham, SW4

## Voltaire Road, SW4

### 2 Bedroom Flat

APPROXIMATE GROSS INTERNAL AREA: 634 SQ FT / 59 SQ M

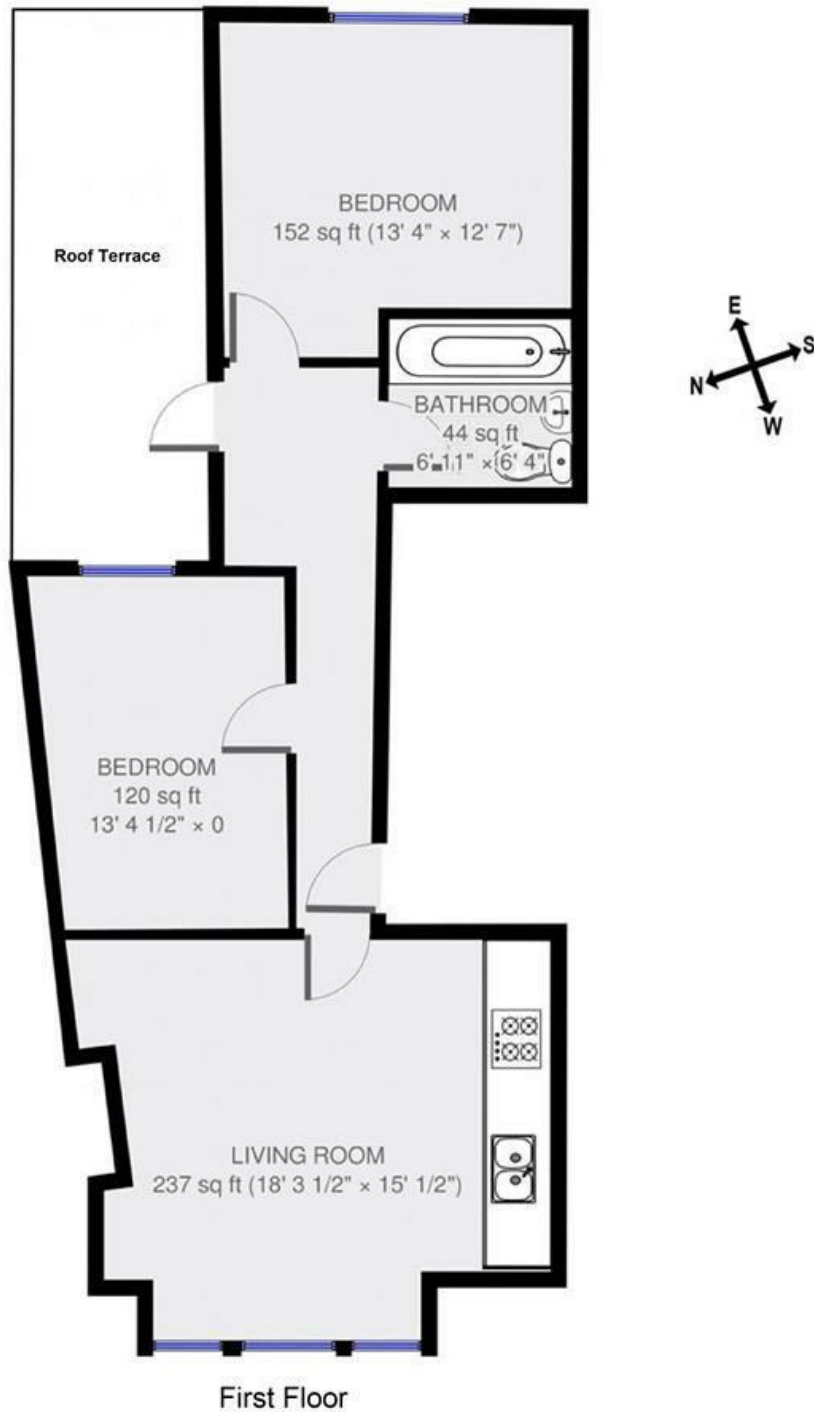

While we try our very best, floor plans are produced as a guide only and we take no responsibility for the precise accuracy with which any property is represented.



Voltaire Road, Clapham, SW4

